

QUICK REFERENCE GUIDE for Lantus® SoloSTAR®

insulin glargine [rDNA origin] injection

These instructions are supplied as a guide only. **Read the full instruction leaflet before you use Lantus® SoloSTAR® for the first time.** If you have any questions, ask your doctor or nurse or call the 24-hour support line shown below.

Step 1: Attach a new needle

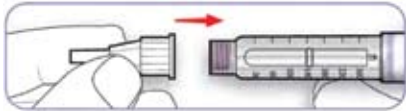

- Lantus SoloSTAR works with both push-on and screw-on needles. Kaiser Permanente members should use only the BD Ultra Fine screw-on needles supplied by Kaiser Permanente pharmacies.
- Remove the protective tab from the needle.
- Keep the needle straight as you attach it to the pen.
- Screw the BD needle on tightly.

Step 2: Do a safety test

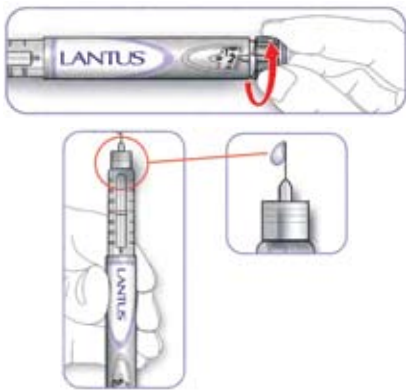

- Always do a safety test before each injection to remove air bubbles and make sure that the pen and needle are working properly.
- Select a dose of 2 units.
- Take off the outer needle cap.
- Hold the pen with the needle pointing upward and press the injection button all the way in.
- Check if insulin comes out of the needle.
- If insulin does not come out, repeat the test until it does.
- If no insulin comes out after the third time, try again with a new needle.

Step 3: Select Your Dose

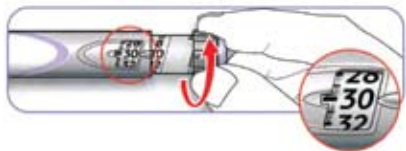

- Be sure the dose window shows "0" following the safety test.
- Select your required dose. (This example shows 30 units.)

Step 4: Inject Your Dose



- Using the method your doctor or nurse showed you, insert the needle into the skin.
- Press the injection button in all the way.
- Hold the button in that position, **slowly count to 10, then withdraw the needle.**

Step 5: Remove the Needle

- Put the outer needle cap back on the needle and use it to unscrew the needle from the pen.
- Dispose of the needle safely, as instructed by your doctor or nurse (e.g., in a sharps container).
- Put the cap on the pen.

Please see accompanying full prescribing information for Lantus®.

Please see Important Safety Information on reverse side.

Helpful hints:

- **If you can't** dial to the dose you want, check if you have enough insulin in the reservoir.
- **If you have** any other problems with the pen, first try changing the needle and repeating the safety test.
- **Each Lantus® SoloSTAR®** is for use by one person only.

If you have any questions or concerns, contact the 24-hour support line for Lantus® SoloSTAR® at 1-800-633-1610

Important Safety Information for Lantus® insulin glargine [rDNA origin] injection

Prescription Lantus® is for adults with type 2 diabetes or adults and children (6 years and older) with type 1 diabetes who require long-acting insulin for the control of high blood sugar.

Lantus® SoloStar® is a disposable insulin delivery device (insulin pen). **Needles and the SoloStar® pen must not be shared.**

DO NOT DILUTE OR MIX LANTUS® WITH ANY OTHER INSULIN OR SOLUTION. It will not work as intended, and you may lose blood sugar control, which could be serious. Do not change your insulin without talking with your doctor. The syringe must not contain any other medication or residue. You should not use Lantus® if you are allergic to insulin. Lantus® is a long-acting insulin you inject just once a day, at the same time each day. **You must test your blood sugar levels while using an insulin such as Lantus®.**

The most common side effect of insulin, including Lantus®, is hypoglycemia, which may be serious. Other possible side effects may include injection site reactions, including changes in fat tissue at the injection site, and allergic reactions, including itching and rash. In rare cases, some allergic reactions may be life threatening. Tell your doctor about other medicines and supplements you are taking because they can change the way insulin works.

Please see accompanying full prescribing information for Lantus®.

For more information on how to use your Lantus® SoloSTAR® pen, please see the full instruction leaflet included with your product.